

**Changes on Camden Street, Crowndale Street and Oakley Square (Map A)**



**Working Men's College**

Right turn ban from Crowndale Road into Oakley Square (except cycles)



New cycle wayfinding sign



SCHEME EXTENTS

SCHEME EXTENTS

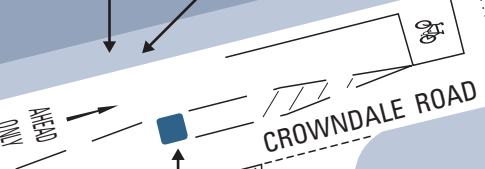

New island to provide protection to turning cyclists

New sign



FOR CONTINUATION SEE MAP B

FOR CONTINUATION SEE MAP C

Indicative designs that may be subject to change

**Key**

- Bus stop flag
- Wands used along some cycle lanes

**Changes on Oakley Square (Map B)**

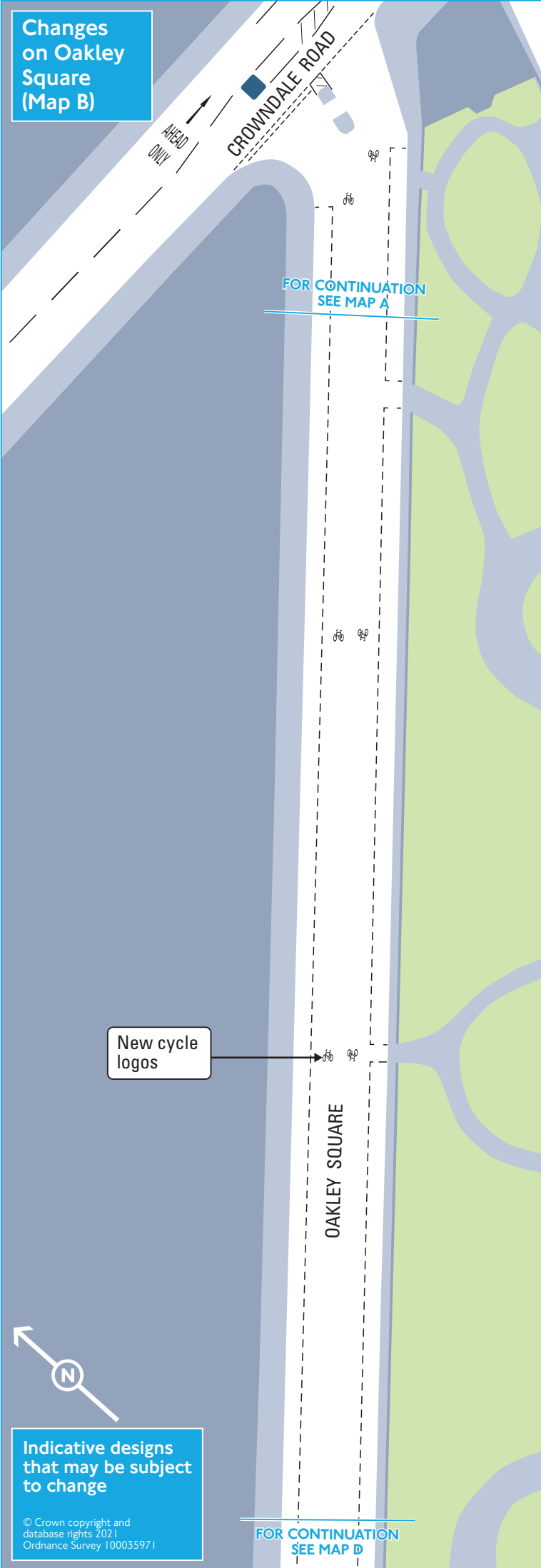

**Changes on Oakley Square (Map C)**

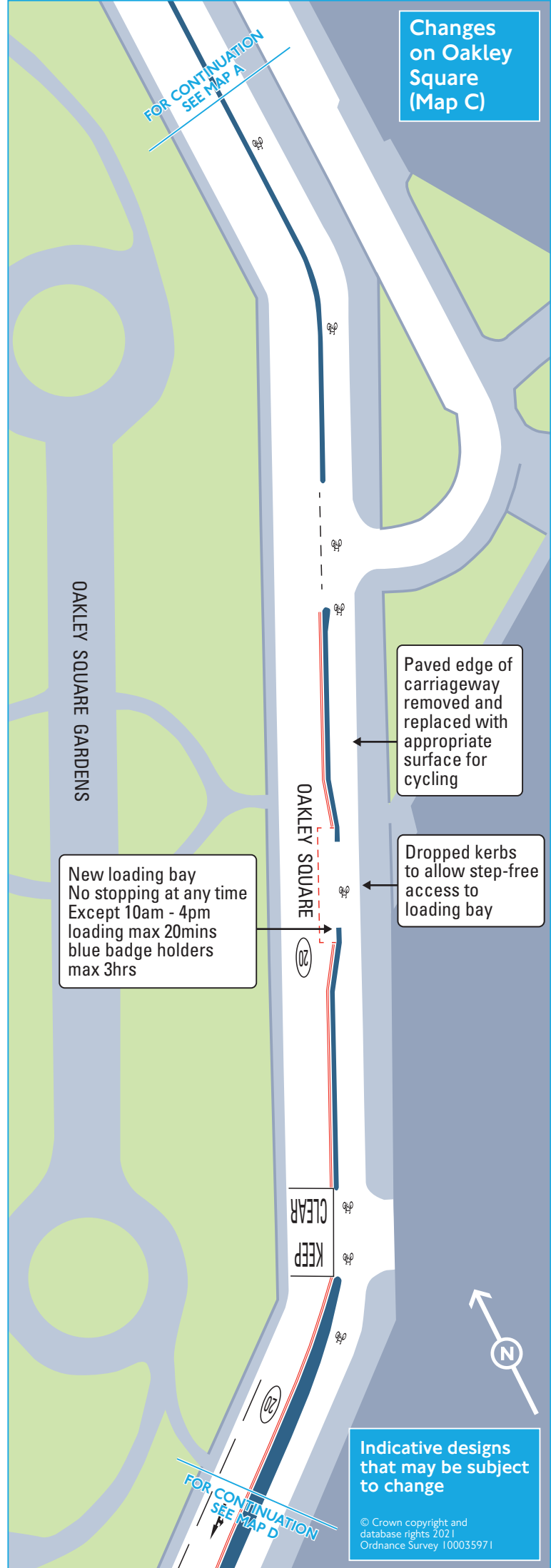

**Changes on Oakley Square and Lidlington Place (Map D)**

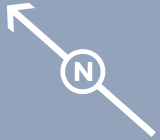

FOR CONTINUATION  
SEE MAP B

FOR CONTINUATION  
SEE MAP C

New cycle logos

Right turn ban from Oakley Square into Eversholt Street for safety of oncoming cyclists from Lidlington Place



New island replacing wands to provide protection to cyclists

Pavement built-out with new sign



Removing the existing banned left turn from Oakley Square (southern side) into Eversholt Street

EVERSHOLT STREET

New right turn pocket to provide protection to turning cyclists

New cycle wayfinding sign



New signs



Two stage right turn for cyclists from Lidlington Place into Eversholt Street (with pocket)

New sign



New cycle wayfinding sign



Existing parking bay converted to loading bay  
No stopping Mon to Sat 7am - 7pm, except: loading max 20mins  
blue badge holders max 3hrs

New islands to provide protection to cyclists

Pavement built-out to prevent illegal parking

HARRINGTON SQUARE

New signs



Pavement cut back to make space for mandatory cycle lane

FOR CONTINUATION  
SEE MAP E

Indicative designs that may be subject to change

# Changes on Harrington Square and Hampstead Road (Map E)

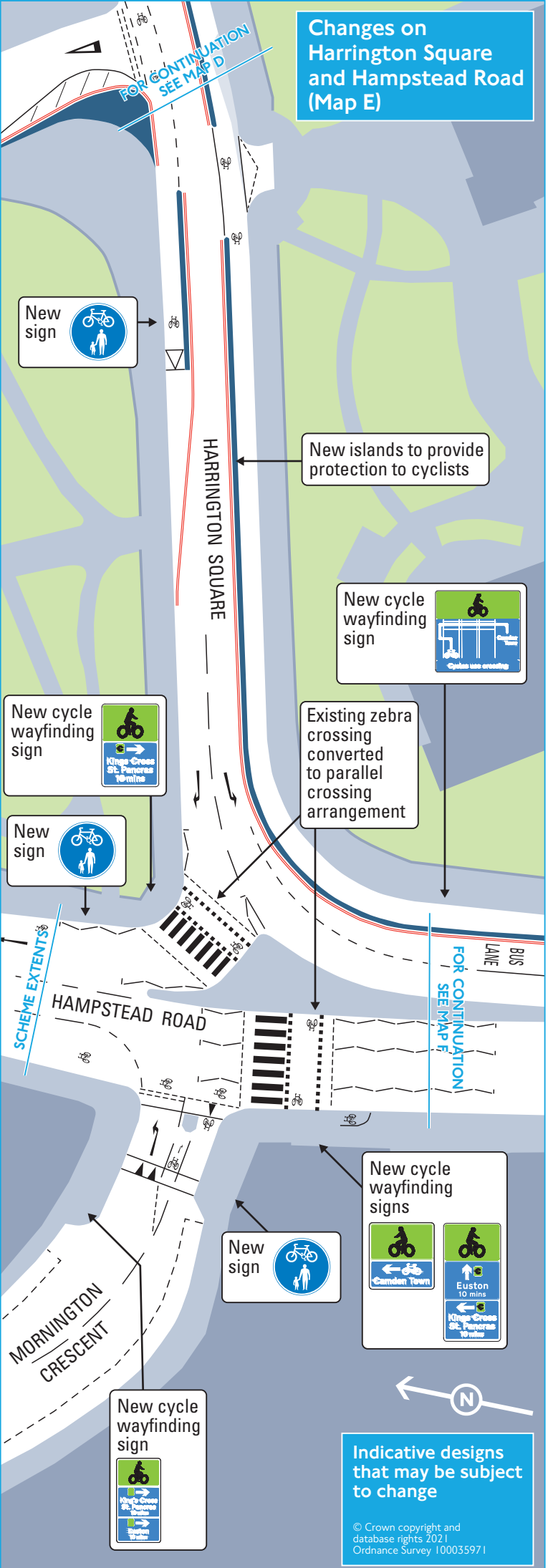

# Changes on Hampstead Road (Map F)

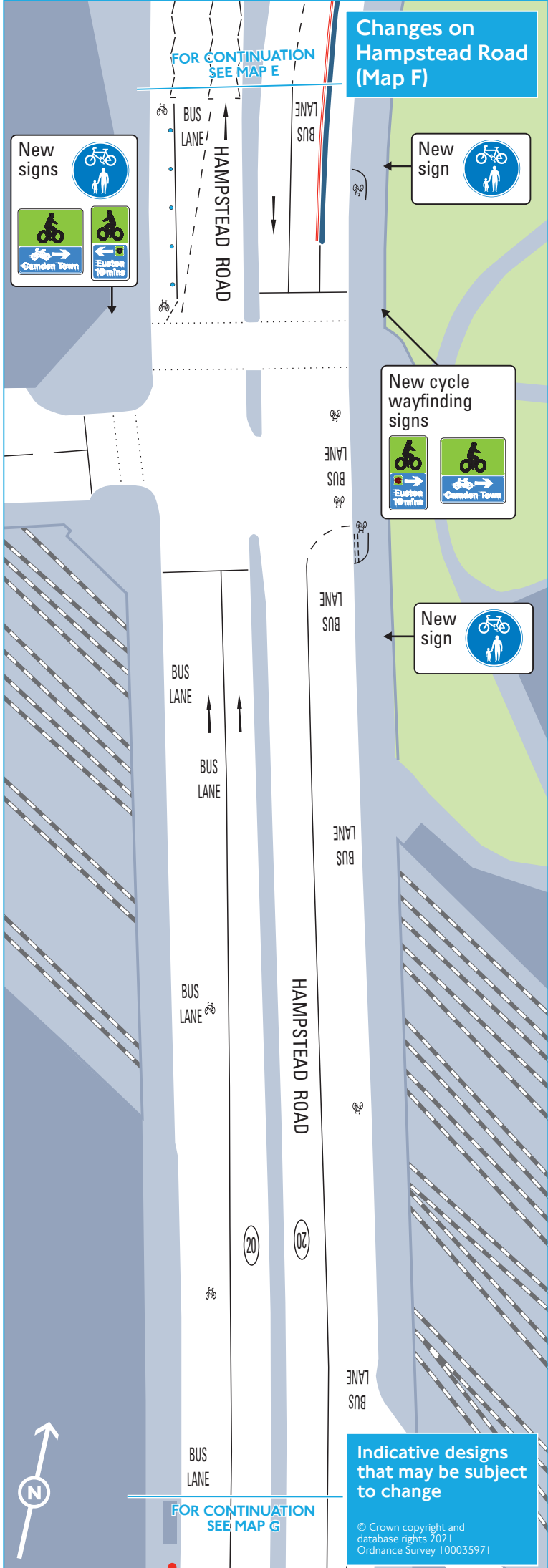

# Changes on Hampstead Road (Map G)



FOR CONTINUATION  
SEE MAP F

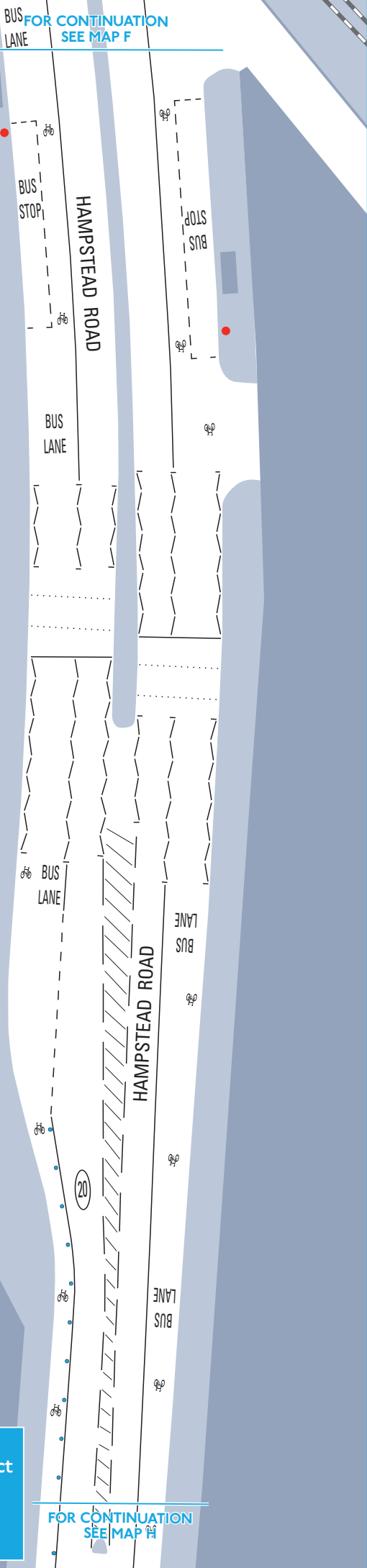

Indicative designs that may be subject to change

FOR CONTINUATION  
SEE MAP H

# Changes on Hampstead Road (Map H)



FOR CONTINUATION  
SEE MAP G

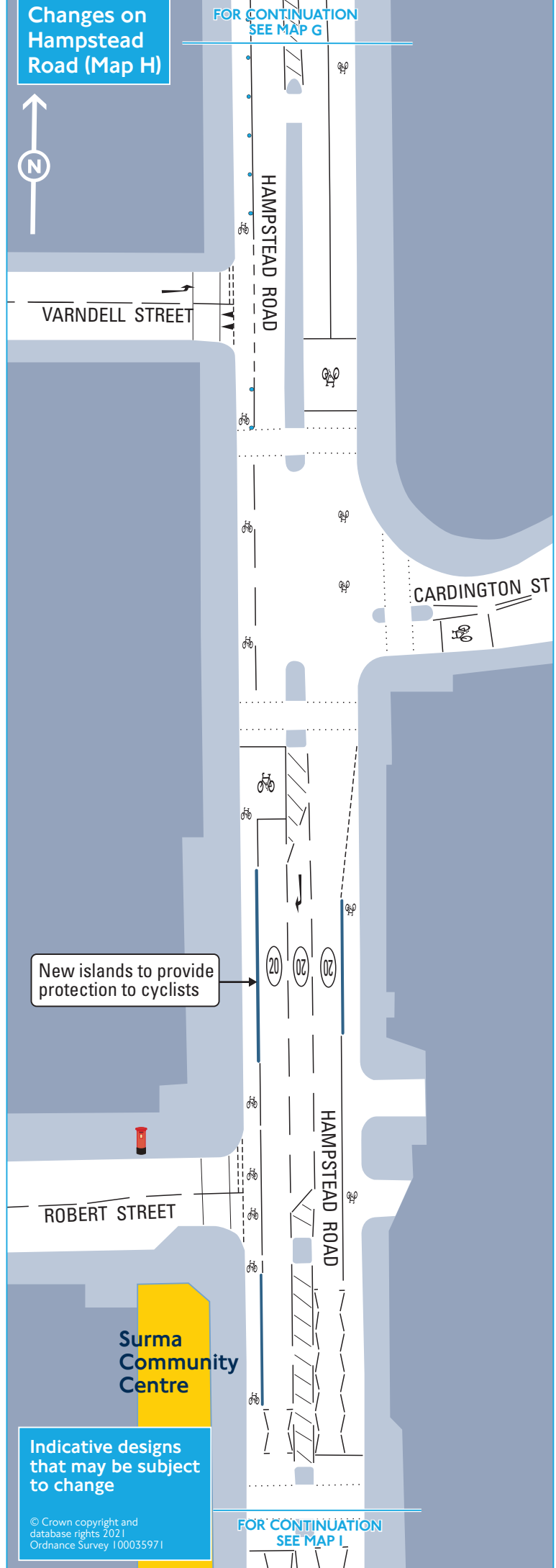

New islands to provide protection to cyclists

Indicative designs that may be subject to change

FOR CONTINUATION  
SEE MAP I

Surma  
Community  
Centre

# Changes on Hampstead Road (Map I)

FOR CONTINUATION SEE MAP H



Surma Community Centre

Wands to protect cyclists retained

Existing bus stop bypass extended to replace temporary barriers

New islands to provide protection to cyclists

Bus stop J remains re-located

Right turn ban from Hampstead Road into William Street (except cycles)



WILLIAM ROAD

Indicative designs that may be subject to change

FOR CONTINUATION SEE MAP J

© Crown copyright and database rights 2021  
Ordnance Survey 100035971

# Changes on Hampstead Road (Map J)

FOR CONTINUATION SEE MAP I



New island to provide protection to cyclists

Pavement cut back to make space for widening of southbound bus lane

Shelter re-located to south

Shelter re-located from north

New bus stop R and shelter

Bus stop U retained from temporary scheme

Euston Tower

Indicative designs that may be subject to change

FOR CONTINUATION SEE MAP K

© Crown copyright and database rights 2021  
Ordnance Survey 100035971

# Changes on Hampstead Road and Tottenham Court Road (Map K)

FOR CONTINUATION SEE MAP J



**Euston Tower**

Existing 30mph sign removed

Existing 30mph sign replaced with 20mph sign 

HAMPSTEAD ROAD

BUS LANE

EUSTON ROAD

EUSTON ROAD

EUSTON ROAD

New sign 

Carriageway width reduced to protect cyclists from being undertaken

20mph repeater sign 

EUSTON ROAD

Left turn ban from Tottenham Court Road into Euston Road (except buses and cycles) 

New section of bus lane

**Warren Street**



Existing 30mph sign replaced with 20mph sign 

20mph repeater sign 

WARREN STREET

**University College Hospital (UCH)**

Existing 30mph sign replaced with 20mph sign 

TOTTENHAM COURT ROAD

BEAUMONT PLACE

Indicative designs that may be subject to change

© Crown copyright and database rights 2021  
Ordnance Survey 100035971

SCHEME EXTENTS